

Empty Lot / Parking  
164' x 60'+

Wessnersville Road

← 170' →

Route 737

← 100' →

Alley

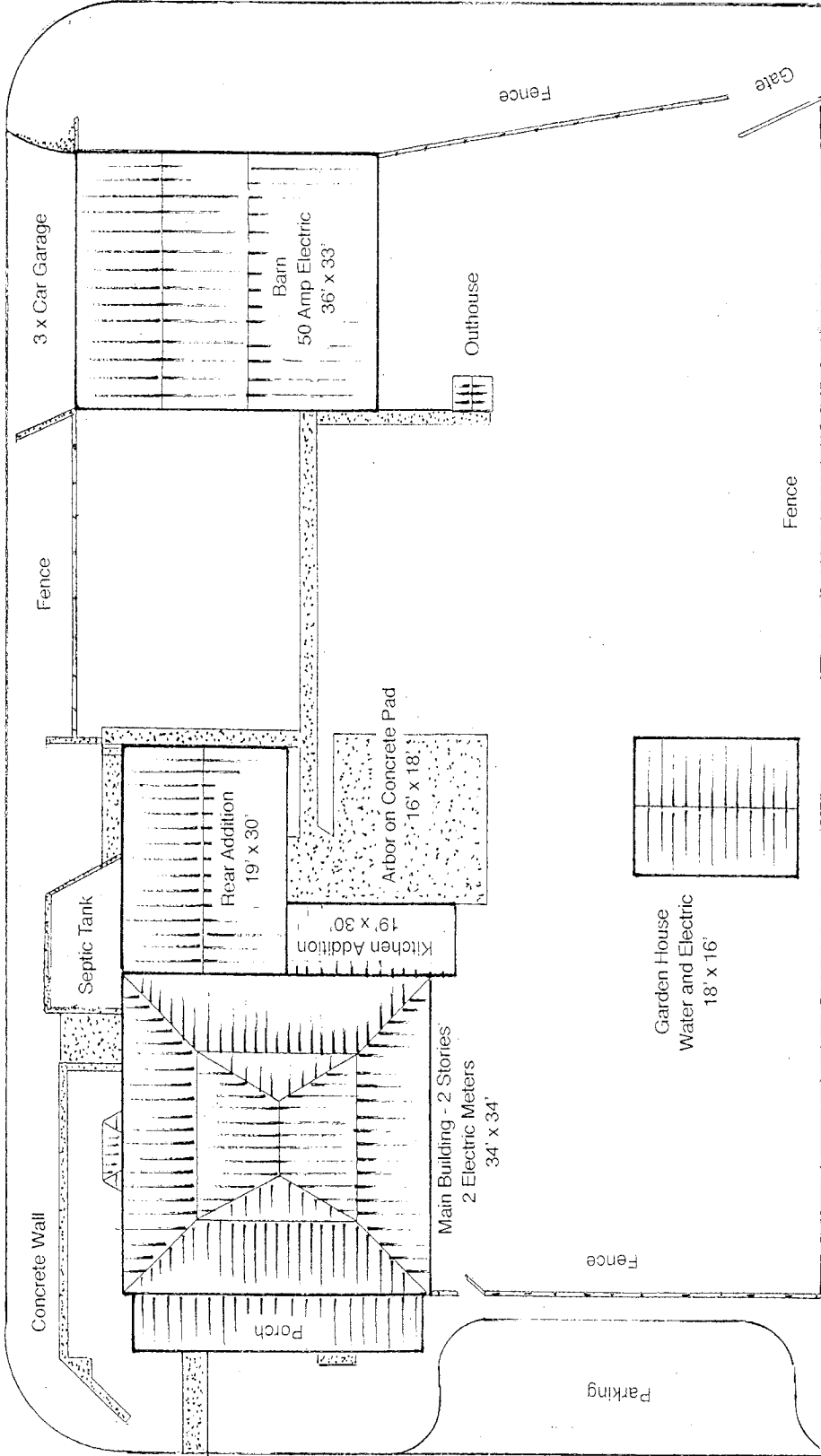

Dimensions are approximate

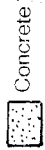

### SITE PLAN

**Includes 3 Buildings and Empty Lot**

Zoned "Village Center" — Commercial / Residential

2471-2467 Route 737, Stony Run, PA 19529

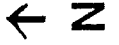

# SITE PLAN

Dimensions are approximate

